

## RADA MONO-CONTROL SYSTEM MC126



- WRAS Approved
- Hygiene 'non-touch' automatic urinal flushing
- Ceiling mounted for 'non-touch' control of a single urinal
- Programmable flush times provides flexibility and greater economy
- Automatic duty flush when building unoccupied
- All elements linked via safe extra low voltage (12 Volts) supply

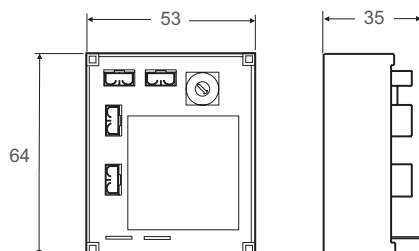
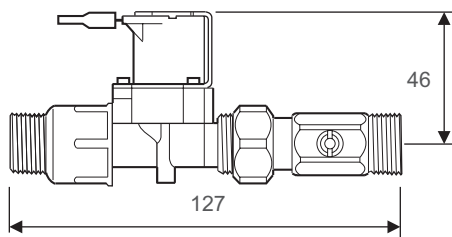
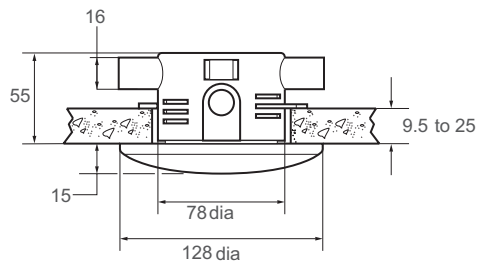

## Dimensions (mm)

**Specify as: Mono-Control System MC126 (1.1495.013)**

Each group of urinal bowls to be served by one Rada Mono-Control System MC126 ceiling mounted flow control. Complete with concealed passive infra-red sensor, control module and 1/2" solenoid valve with isolator and filter.

## TECHNICAL SPECIFICATION

### Installation and Maintenance

Please refer to the appropriate Product Manual.

When the design of today's washrooms require higher levels of hygiene and energy savings, Rada provide the solution.

Rada Mono-Control systems enable precise control of showering, hand washing and urinal flushing systems.

The ceiling sensor is recessed into false ceilings or ceiling tiles and is supplied with a conduit box, front fixings, plate and cover screws.

The solenoid valve should be accessible for maintenance purposes. Supplied complete with integral isolator and filter.

### Approvals

WRAS approved (Water Regulations Advisory Scheme).

CE Approved.

Designed, manufactured and supported in accordance with accredited BS EN ISO 9001:2008 Quality Management Systems and BS EN ISO 14001:2004 Environmental Management Systems.

### Operation

When the sensor is activated, a signal is sent to the Rada Mono-Control module which initiates a delay, after which the solenoid valve opens - allowing water to flow through the outlet.

The duration of the flow and the delay can be pre-set, via the Rada Mono-Control module, ensuring optimum saving of water and energy.

### Materials

Ceiling Sensor: Base - ABS, cover - polycarbonate.

Solenoid Valve: Body material fibreglass polyimide.

### Flush Timing

The system provides a flush duration which can be set for 6, 9, 11 or 13 seconds.

This will operate after a flush delay of either 30 seconds, 1 minute, 2 minutes or 3 minutes. These settings can be adjusted via the integral timing dial.

A duty flush is incorporated, every 24 hours after usage.

The Control Module attaches directly onto the solenoid valve.

### Pressures

Solenoid valve: 0.2 - 10 bar (20 - 1000 kPa).

### Electrical Specification

Protection class: Sensor, electronic module IP55.

Supply voltage: 12V AC + 10% 50/60 HZ, via Rada 302, 308 or 316 transformer (not included).

Power consumption: 6 VA.

Operating ambient temperature range: 5°C - 40°C.

Maximum humidity: 80%.

Wiring form sensor to control module: 2 core PVC covered cable, 3.0 m supplied.

Sensor range: minimum 0.5 metres, maximum 2.5 metres.

### Operation Schematic

